

**RoHS**  
COMPLIANT

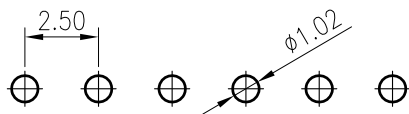
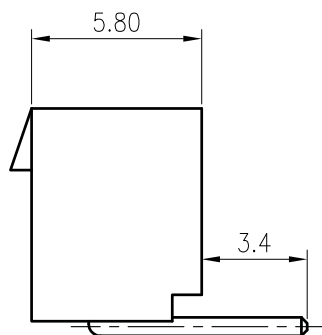
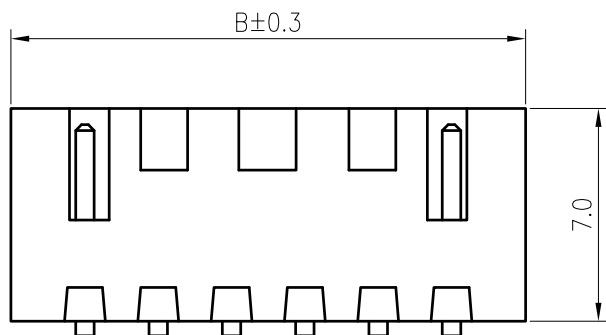
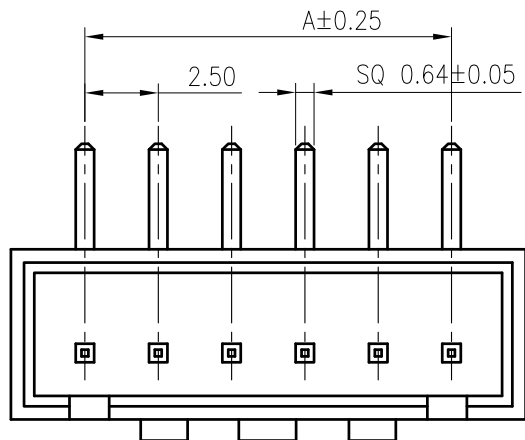

Recommended P.C.B. Layout  
Total tolerance: ±0.05mm

**SPECIFICATIONS**

1. Current rating: 3A AC, DC
2. Voltage rating: 250V AC, DC
3. Temperature range: -40°C ~ +105°C
4. Insulation resistance: 1000MΩ/ min.
5. Withstanding voltage: 1000V AC/ minute.
6. Contact resistance: 20mΩ/ max.

**Material:**

Insulator: PA66 UL94 V-2 or v-0

Contact: Brass

Plating: Tin plated over Nickel

Mate with KR2502 series Housing

**Ordering Code:**

C2502RD xxx 01 T01 01PB

No. of Circuits: 102:02, 116:16  
Plating: T01: Tin plated

Insulator Material:  
03: PA66 White V2  
20: PA66 Red V0  
21: PA66 Blue V0  
22: PA66 Beige V0  
31: PA66 Green V0

Circuits	Dimensions		Circuits	Dimensions	
	A	B		A	B
2	2.50	7.50	10	22.50	27.50
3	5.00	10.00	11	25.00	30.00
4	7.50	12.50	12	27.50	32.50
5	10.00	15.00	13	30.00	35.00
6	12.50	17.50	14	32.50	37.50
7	15.00	20.00	15	35.00	40.00
8	17.50	22.50	16	37.50	42.50
9	20.00	25.00	18	42.50	47.50

TOLERANCE  
X.X ±0.30  
X.XX ±0.20  
X.XXX ±0.10  
Angle ±2°

TITLE:  
XH2.5 Have buckle  
DIP 90° Wafer

DRAWN: Shen 2022.01.13

CHECKED:

APPROVED:

**KONNRA** 东莞市康瑞电子有限公司  
DongGuan Konnra Electronics Co., Ltd.

PART NO.: C2502RDxxxxxT0101PB



Uniformly arrange the drawings

Shen

2022.01.13

MARK

REVISION DESCRIPTION

SIGNATURE

DATE

UNIT: mm

SCALE: N/A

SHEET: 1/1

PROJECTION

REV.: A4

DRAWING NO.: 2502WRD101-B-S