

**RoHS**  
COMPLIANT

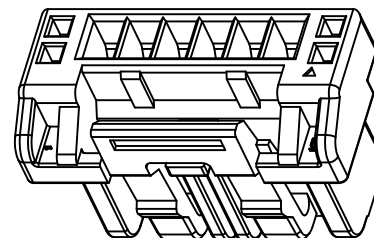
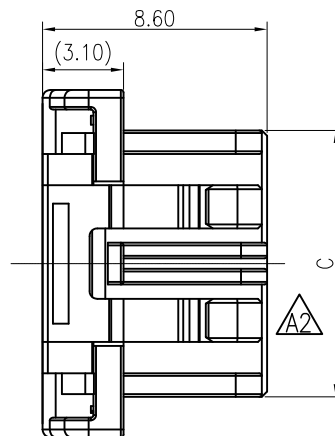
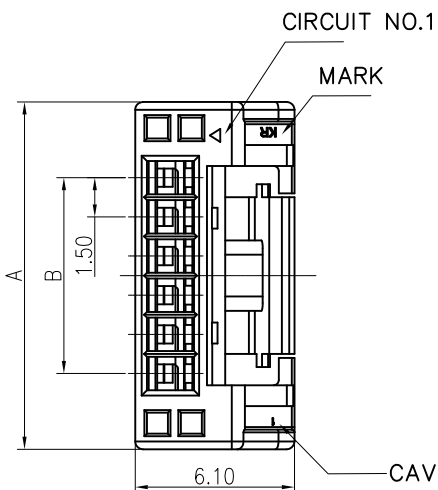
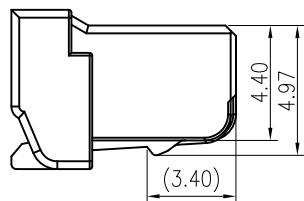

**SPECIFICATIONS**

1. Current rating: 3A (AWG #24)AC, DC
2. Voltage rating: 100V AC,DC
3. Temperature range: -40°C ~ +105°C
4. Insulation resistance:500MΩ Min.
5. Withstanding voltage: 500V AC/ minute.
6. Contact resistance: 20mΩ Max.

Material: PBT UL94 V-0  
Suitable: KR1507 series terminal  
Mate with KR1507 series wafer

Ordering Code:

H15070 \*\*\* 24 01A

No.of Circuits

102:02,  
115:15

Insulator Material  
24:PBT White

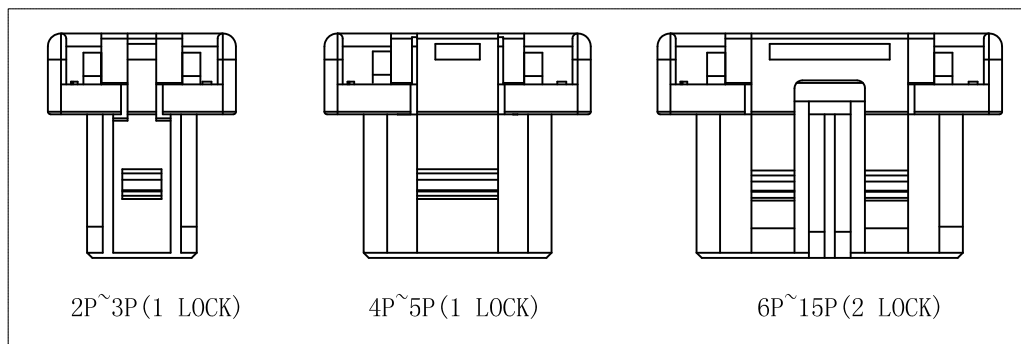

15P	26.80	21.00	23.70
14P	25.30	19.50	22.20
13P	23.80	18.00	20.70
12P	22.30	16.50	19.20
11P	20.80	15.00	17.70
10P	19.30	13.50	16.20
9P	17.80	12.00	14.70
8P	16.30	10.50	13.20
7P	14.80	9.00	11.70
6P	13.30	7.50	10.20
5P	11.80	6.00	8.70
4P	10.30	4.50	7.20
3P	8.80	3.00	5.70
2P	7.30	1.50	4.20
PIN数	A	B	C

LTR		REVISION DESCRIPTION	SIGNATURE	DATE	TOLERANCE	TITLE:	DRAWN:	KONNRA 东莞市康瑞电子有限公司			
F	A3	Uniformly arrange the drawings	Shen	2021.09.17	X.X ±0.30	MX1.5 Inner buckle Housing	Shen 2021.09.17	DongGuan Konnra Electronics CO.,LTD			
	A2	Delete Size	Arvin	2020.11.20	X.XX ±0.20		CHECKED:				
					X.XXX ±0.10	APPROVED:		PART NO.:H150701**2401A			
					Angle ±3°	UNIT:mm	SCALE:1/1	SHEET:1/1	PROJECTION	VER.:A3	DRAWING NO.:1507H101-A-S

**RoHS**  
COMPLIANT

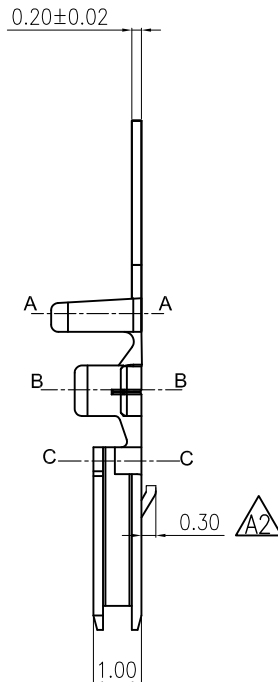
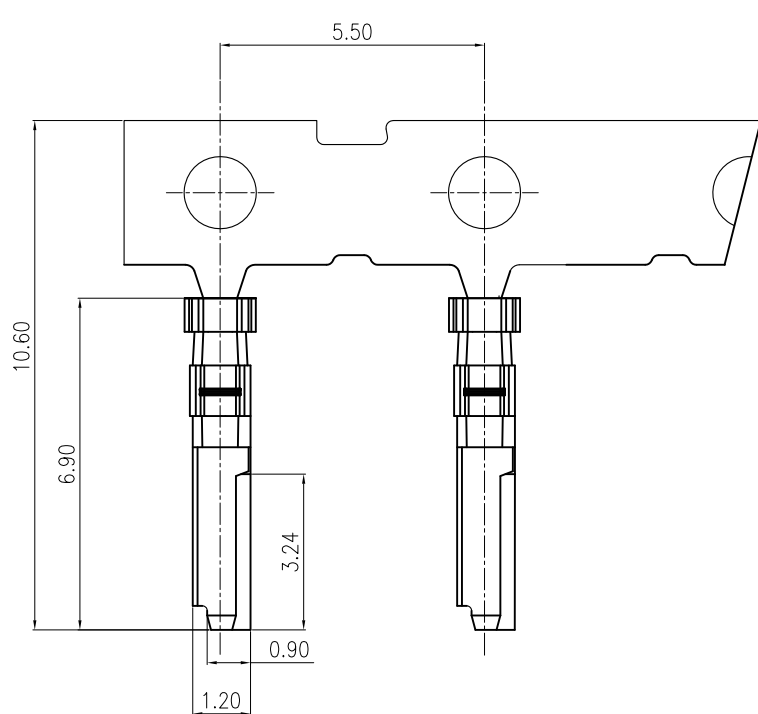

**SPECIFICATIONS**

1. Current rating: 3A (AWG #24)AC, DC
2. Voltage rating: 100V AC,DC
3. Temperature range: -40°C ~ +105°C
4. Insulation resistance: 500MΩ Min.
5. Withstanding voltage: 500V AC/ minute.
6. Contact resistance: 20mΩ Max.

Material: Phosphor Bronze  
 Finish: TIN plated over Nickel  
 Applicable wires: AWG #24~#28  
 Insulation O.D 0.78~1.28 mm  
 Qty/reel: 10,000 PCS

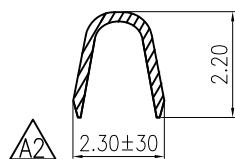

SECTION A-A

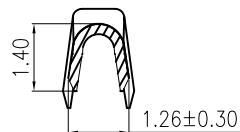

SECTION B-B

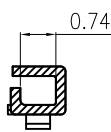

SECTION C-C

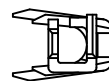

F		Uniformly arrange the drawings	Shen	2021.09.17	TOLERANCE X.X ±0.30 X.XX ±0.20 X.XXX ±0.10 Angle ±3°	TITLE: MX1.5 Inner buckle Terminal	DRAWN: Shen 2021.09.17		KONNRA 东莞市康瑞电子有限公司		
		Change the part number and frame format	Arvin	2020.11.20			CHECKED:		DongGuan Konnra Electronics CO.,LTD		
	LTR REVISION DESCRIPTION		SIGNATURE	DATE			APPROVED:		PART NO.: T15070PT0101A		
	1	2	3	4	UNIT:mm	SCALE: 1/1	SHEET: 1/1	PROJECTION	VER.: A3	DRAWING NO.: 1507T101-A-S	
	1	2	3	4	5	6	7	8	9		

**RoHS**  
COMPLIANT

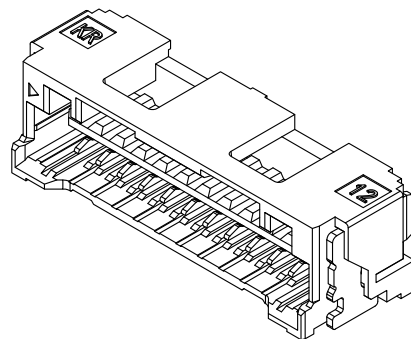
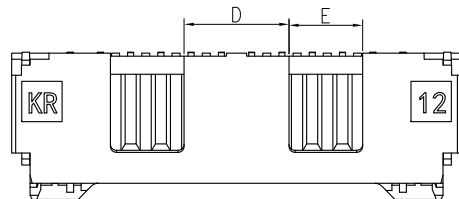

**SPECIFICATIONS**

1. Current rating: 3A (AWG #24)AC, DC
2. Voltage rating: 100V AC,DC
3. Temperature range: -40°C ~ +105°C
4. Insulation resistance:500MΩ Min.
5. Withstanding voltage: 500V AC/ minute.
6. Contact resistance: 20mΩ Max.

**Material:**

Insulator: PA9T UL 94V-0

Pin: Phosphor bronze

**A3** Fitting Nail: Brass

Plating: Tin plated over Nickel

Mate with KR1507 series Housing

**PART NO:**

C1507VS1\*\*11M0101RA

02: 2P

16: 16P

11: PA9T Natural

M01: Matte Tin

R: Reel  
P: Bag

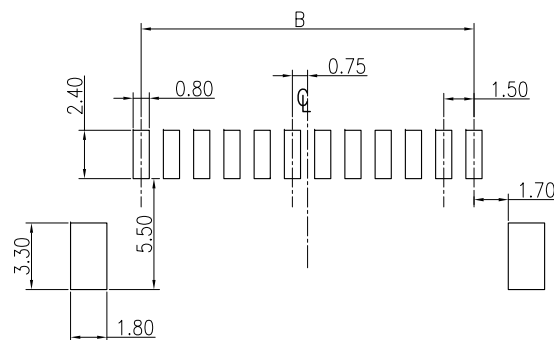
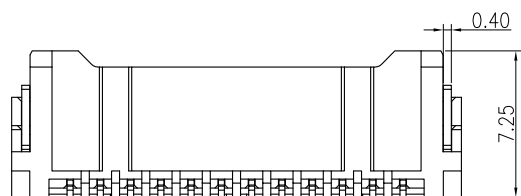
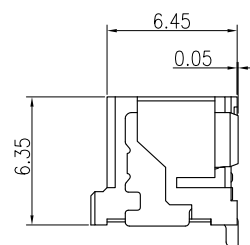
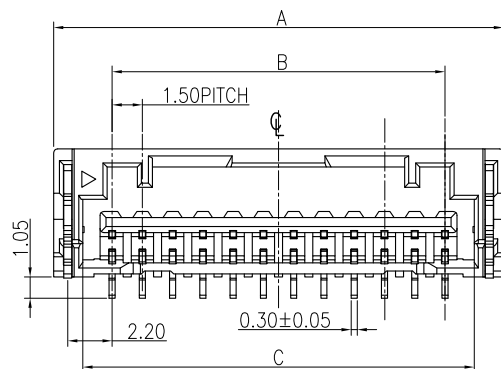

Recommended P.C.B. Layout  
Total tolerance:±0.05mm

15P	26.80	21.00	23.90	5.20	3.65	
14P	25.30	19.50	22.40	5.20		
13P	23.80	18.00	20.90	5.20		
12P	22.30	16.50	19.40	5.20		
11P	20.80	15.00	17.90	5.20		
10P	19.30	13.50	16.40	3.20		
9P	17.80	12.00	14.90	3.20		
8P	16.30	10.50	13.40	2.50		3.25
7P	14.80	9.00	11.90	2.50		2.50
6P	13.30	7.50	10.40	2.30		2.15
5P	11.80	6.00	8.90	—	3.60	
4P	10.30	4.50	7.40	—	3.30	
3P	8.80	3.00	5.90	—	2.55	
2P	7.30	1.50	4.40	—	1.85	
PIN	A	B	C	D	E	

F	<b>A4</b>	Uniformly arrange the drawings	Shen	2021.09.08	TOLERANCE X.X ±0.30 X.XX ±0.20 X.XXX ±0.10 Angle ±2°	TITLE: MX1.5 SMT 180° INNER BUCKLE WF	DRAWN: Shen 2021.09.08		KONNRA 东莞市康瑞电子有限公司 DongGuan Konnra Electronics Co.,Ltd.		
	<b>A3</b>	Change the table	Arvin	2020.11.20			CHECKED:				
	MARK	REVISION DESCRIPTION	SIGNATURE	DATE	UNIT:mm	SCALE:1/1	SHEET:1/2	PROJECTION	REV.:A4	PART NO.:C1507VS1**11M0101RA	
	1	2	3	4	5	6	7	8	9	DRAWING NO.:1507WVS101-A-S	

**RoHS**  
COMPLIANT

2P VIEW

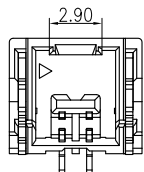

3P VIEW

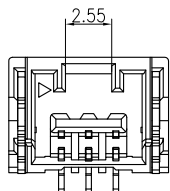

4P VIEW

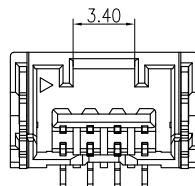

5P VIEW

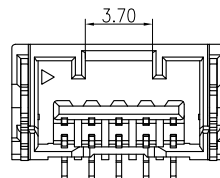

6P VIEW

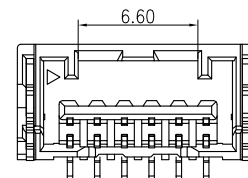

7P VIEW

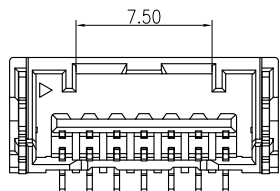

8P VIEW

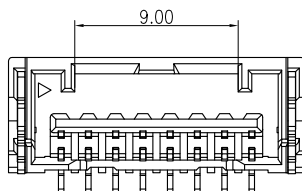

9P VIEW

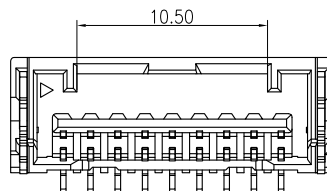

10P VIEW

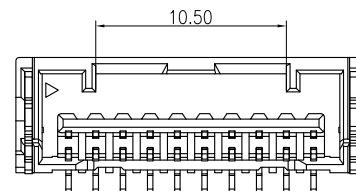

11P VIEW

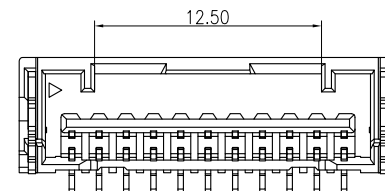

13P VIEW

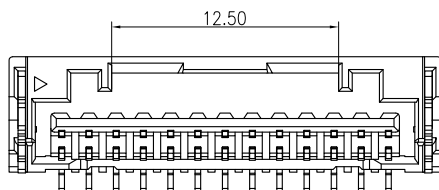

14P VIEW

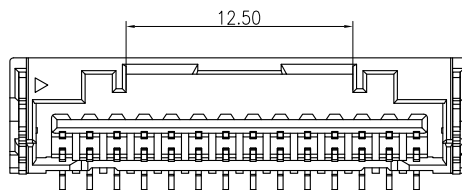

15P VIEW

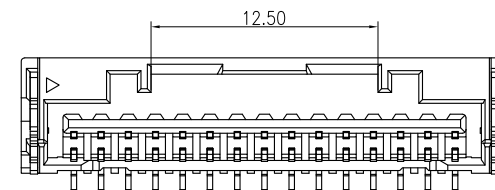

A3

A2

A1

MARK

Uniformly arrange the drawings

Change the table

REVISION DESCRIPTION

Shen

Arvin

SIGNATURE

2021.09.08

2020.11.20

DATE

TOLERANCE

X.X ±0.30

X.XX ±0.20

X.XXX ±0.10

Angle ±2°

TITLE:

MX1.5 SMT 180°  
INNER BUCKLE WF

UNIT:mm

SCALE:1/1

DRAWN: Shen 2021.09.08

CHECKED:

APPROVED:

SHEET:2/2

PROJECTION

**KONNRA** 东莞市康瑞电子有限公司  
DongGuan Konnra Electronics Co.,Ltd.

PART NO.:C1507VS1\*\*11M0101RA

REV.:A4

DRAWING NO.:1507WVS101-A-S

1

2

3

4

5

6

7

8

9

**RoHS**  
COMPLIANT

**SPECIFICATIONS**

1. Current rating: 3A (AWG #24)AC, DC
2. Voltage rating: 100V AC,DC
3. Temperature range: -40°C ~ +105°C
4. Insulation resistance:500MΩ Min.
5. Withstanding voltage: 500V AC/ minute.
6. Contact resistance: 20mΩ Max..

**Material:**

Insulator: PA9T UL 94V-0  
Pin: Phosphor bronze  
Fitting Nail: Brass  
Plating: Tin plated over Nickel  
Mate with KR1507 series Housing

PART NO: C1507RS1\*\*11M0101RA

02: 2P  
16: 16P  
11:PA9T Natural  
M01: Matte Tin  
R: Reel  
P: Bag

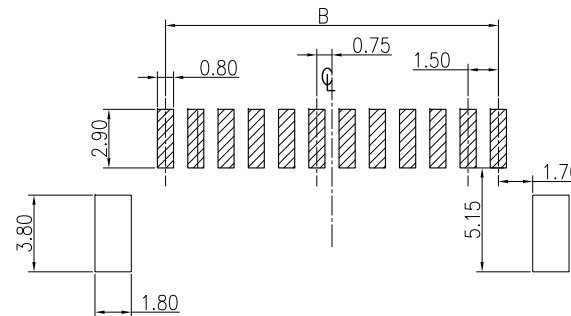
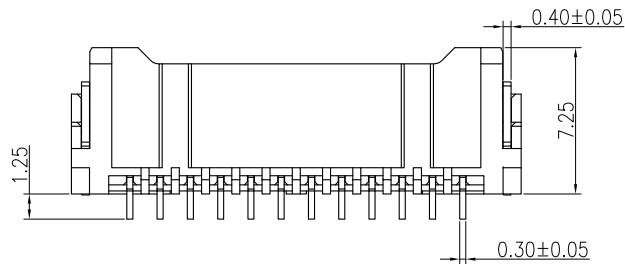
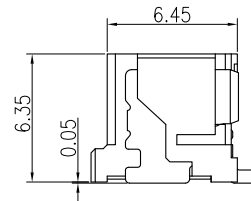
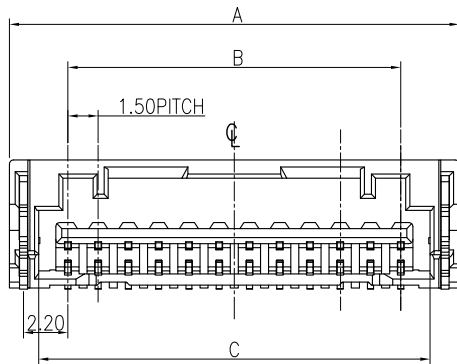
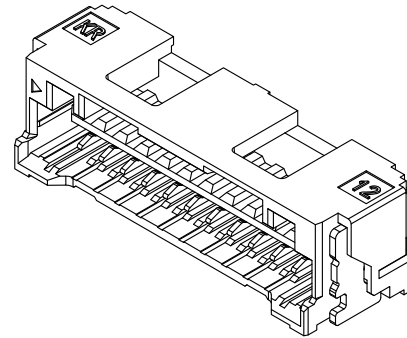
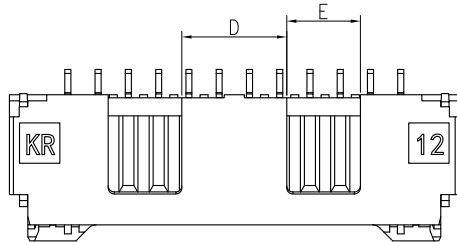

Recommended P.C.B. Layout  
Total tolerance:±0.05mm

15P	26.80	21.00	23.90	5.20	3.65	
14P	25.30	19.50	22.40	5.20		
13P	23.80	18.00	20.90	5.20		
12P	22.30	16.50	19.40	5.20		
11P	20.80	15.00	17.90	5.20		
10P	19.30	13.50	16.40	3.20		
9P	17.80	12.00	14.90	3.20		
8P	16.30	10.50	13.40	2.50		3.25
7P	14.80	9.00	11.90	2.50		2.50
6P	13.30	7.50	10.40	2.30		2.15
5P	11.80	6.00	8.90	—	3.60	
4P	10.30	4.50	7.40	—	3.30	
3P	8.80	3.00	5.90	—	2.55	
2P	7.30	1.50	4.40	—	1.85	
PIN	A	B	C	D	E	

F	MARK	REVISION DESCRIPTION	SIGNATURE	DATE	TOLERANCE	TITLE:	DRAWN: Shen 2021.09.28	KONNRA 东莞市康瑞电子有限公司 DongGuan Konnra Electronics Co.,Ltd.		
		1	2	3	X.X ±0.30	MX1.5 SMT 90°	CHECKED:	PART NO.:C1507RS1**11M0101RA		
		2	3	X.XX ±0.20	INNER BUCKLE WF	APPROVED:				
		3	4	X.XXX ±0.10	UNIT:mm	SCALE:1/1	SHEET:1/2	PROJECTION	REV.:A4	DRAWING NO.:1507WHS101-A-S
					Angle ±2°					

**RoHS**  
COMPLIANT

2P VIEW

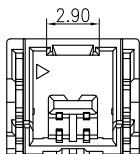

3P VIEW

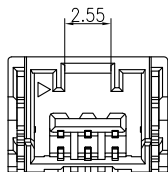

4P VIEW

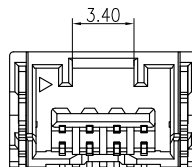

5P VIEW

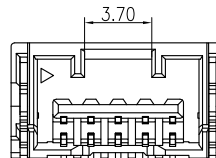

6P VIEW

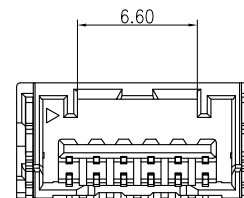

7P VIEW

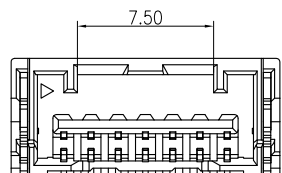

8P VIEW

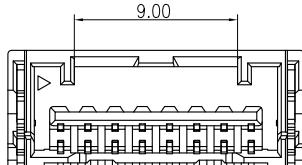

9P VIEW

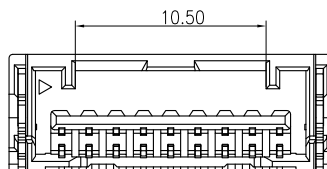

10P VIEW

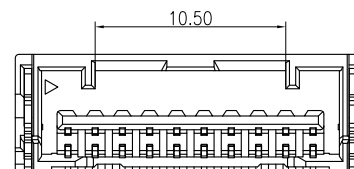

11P VIEW

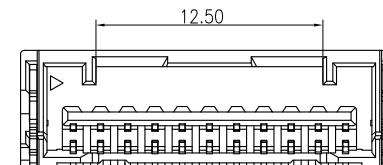

13P VIEW

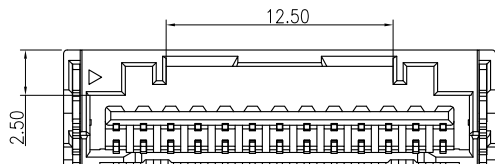

14P VIEW

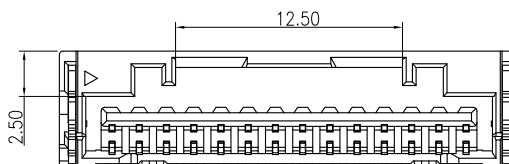

15P VIEW

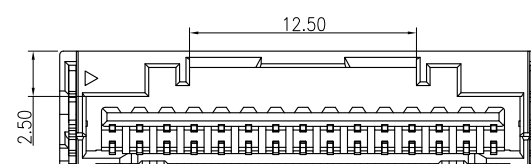

Uniformly arrange the drawings

Shen

2021.09.08

TOLERANCE

X.X ±0.30

X.XX ±0.20

X.XXX ±0.10

Angle ±2°

TITLE:

MX1.5 SMT 90°  
INNER BUCKLE WF

DRAWN: Shen 2021.09.28

CHECKED:

APPROVED:

**KONNRA** 东莞市康瑞电子有限公司

DongGuan Konnra Electronics Co.,Ltd.

PART NO.: C1507RS1\*\*11M0101RA

MARK

REVISION DESCRIPTION

SIGNATURE

DATE

UNIT:mm

SCALE:1/1

SHEET:2/2

PROJECTION

REV.:A4

DRAWING NO.:1507WHS101-A-S

1

2

3

4

5

6

7

8

9

**RoHS**  
COMPLIANT

Material: PBT UL94 V-0  
 Suitable:  
 KR1507 series terminal(24AWG~28AWG)  
 Mate with KR1507 series Dual row Wafer

Ordering Code: H150702xxxx01A

204=2\*4P  
 205=2\*5P

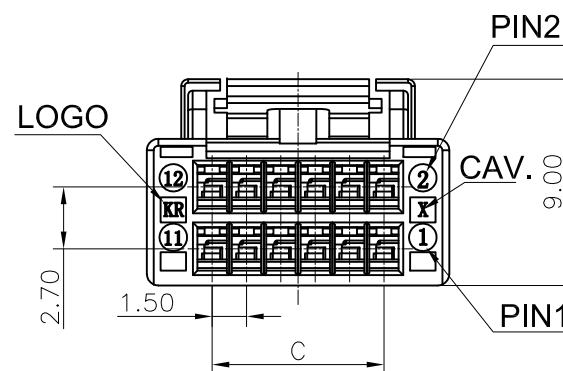
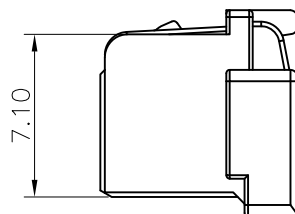
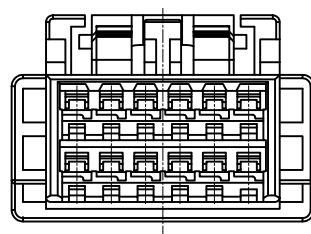
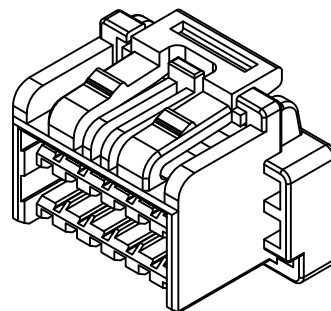
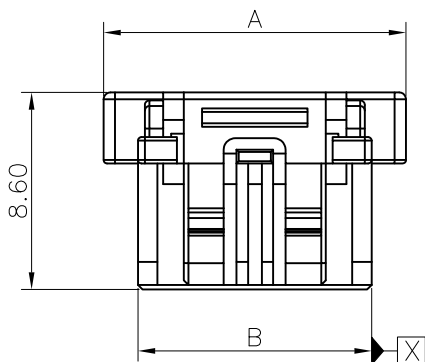

Pin	Dimension		
	A	B	C
2*4P	10.20	7.20	4.50
2*5P	11.70	8.70	6.00
2*6P	13.20	10.20	7.50
2*7P	14.70	11.70	9.00
2*8P	16.20	13.20	10.50
2*9P	17.70	14.70	12.00
2*10P	19.20	16.20	13.50
2*11P	20.70	17.70	15.00
2*12P	22.20	19.20	16.50
2*13P	23.70	20.70	18.00
2*14P	25.20	22.20	19.50
2*15P	26.70	23.70	21.00
2*16P	28.20	25.20	22.50
2*17P	29.70	26.70	24.00
2*18P	31.20	28.20	25.50
2*19P	32.70	29.70	27.00
2*20P	34.20	31.20	28.50

F	A3				TOLERANCE	TITLE:	DRAWN: Shen 2022.05.10	KONNRA 东莞市康瑞电子有限公司 DongGuan Konnra Electronics Co.,Ltd.		
	A2				X.X ±0.30	MX1.5 INNER BUCKLE	CHECKED:			
	A1	NEW DWG	Shen	2022.05.10	X.XX ±0.20	DUAL ROW HOUSING	APPROVED:	PART NO.:H150702xxxx01A		
	MARK	REVISION DESCRIPTION	SIGNATURE	DATE	X.XXX ±0.10	UNIT:mm	SCALE:1/1	SHEET:1/2	PROJECTION	REV.:A1
	1	2	3	4	5	6	7	8	9	

**RoHS**  
COMPLIANT

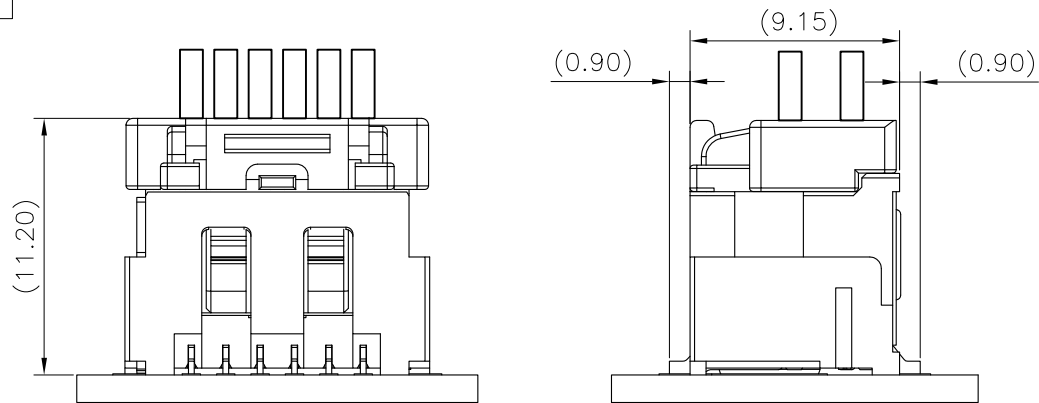

**MATED CONNECTORS**

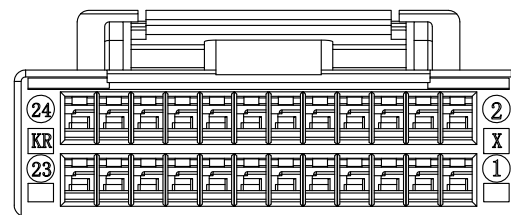
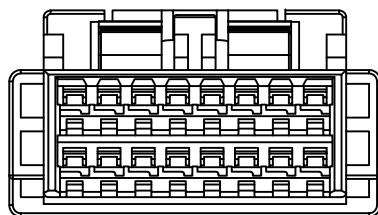
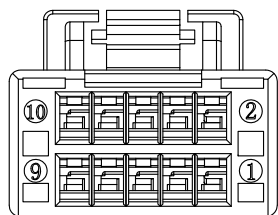
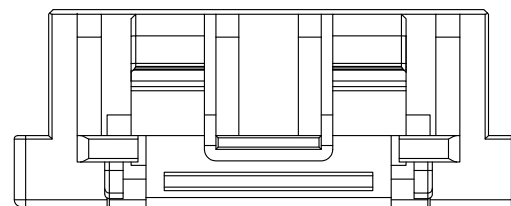
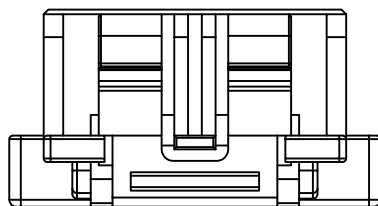
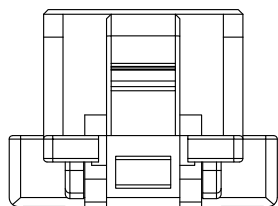

**2x4~2x5PIN**

**2x6~2x9 PIN**

**2x10~2x20PIN**

F					TOLERANCE	TITLE:	DRAWN: Shen 2022.05.10	KONNRA 东莞市康瑞电子有限公司	
					X.X ±0.30	MX1.5 INNER BUCKLE	CHECKED:	DongGuan Konnra Electronics Co.,Ltd.	
		NEW DWG	Shen	2022.05.10	X.XX ±0.20	DUAL ROW HOUSING	APPROVED:	PART NO.:H150702xxxx01A	
	MARK	REVISION DESCRIPTION	SIGNATURE	DATE	X.XXX ±0.10	Angle ±2°	UNIT:mm	SCALE:1/1	SHEET:2/2
	1	2	3	4	5	6	7	8	9



**RoHS**  
COMPLIANT

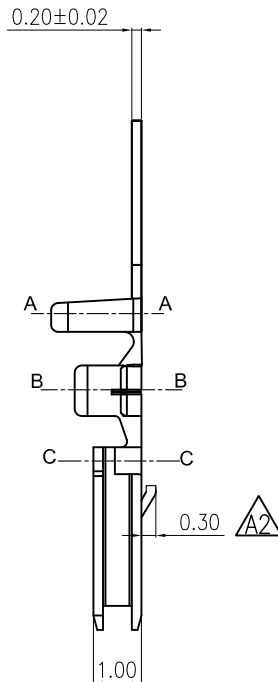
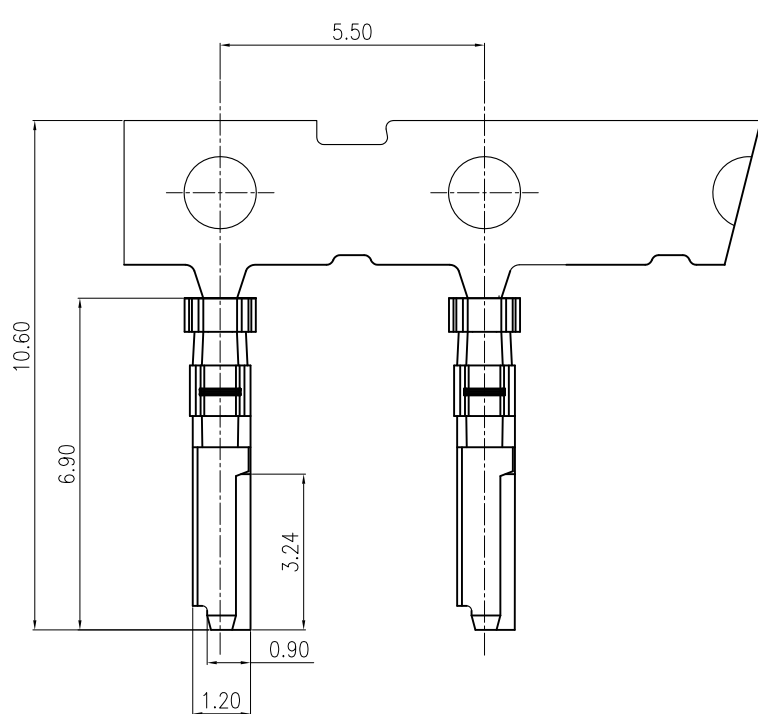

**SPECIFICATIONS**

1. Current rating: 3A (AWG #24)AC, DC
2. Voltage rating: 100V AC,DC
3. Temperature range: -40°C ~ +105°C
4. Insulation resistance: 500MΩ Min.
5. Withstanding voltage: 500V AC/ minute.
6. Contact resistance: 20mΩ Max.



Material: Phosphor Bronze  
 Finish: TIN plated over Nickel  
 Applicable wires: AWG #24~#28  
 Insulation O.D 0.78~1.28 mm  
 Qty/reel: 10,000 PCS

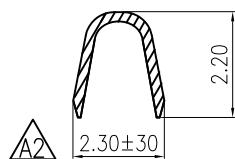

SECTION A-A

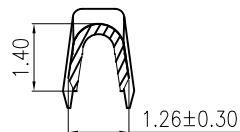

SECTION B-B

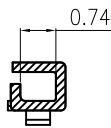

SECTION C-C

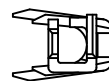

F		Uniformly arrange the drawings	Shen	2021.09.17	TOLERANCE X.X ±0.30 X.XX ±0.20 X.XXX ±0.10 Angle ±3°	TITLE: MX1.5 Inner buckle Terminal	DRAWN: Shen 2021.09.17		KONNRA 东莞市康瑞电子有限公司		
		Change the part number and frame format	Arvin	2020.11.20			CHECKED:		DongGuan Konnra Electronics CO.,LTD		
	LTR REVISION DESCRIPTION		SIGNATURE	DATE			APPROVED:		PART NO.: T15070PT0101A		
	1	2	3	4	UNIT:mm	SCALE: 1/1	SHEET: 1/1	PROJECTION	VER.: A3	DRAWING NO.: 1507T101-A-S	
	1	2	3	4	5	6	7	8	9		

**RoHS**  
COMPLIANT

**SPECIFICATIONS**

1. Current rating: 1.5A AC, DC
2. Voltage rating: 100V AC, DC
3. Temperature range: -40°C ~ +105°C
4. Insulation resistance: 100MΩ/ min.
5. Withstanding voltage: 500V AC/ minute.
6. Contact resistance: 20mΩ/ max.

**Material:**

Insulator: PA9T UL 94V-0

Contact: Copper alloy

Nail: Copper alloy

Plating: 1um MIN Matte Tin plated over Nickel

Circuits: 2\*4~2\*20

Mates With KR1507 Series Dual Row Housing

Ordering Code: C1507RS2xx11M0101RA

204=2\*4P

205=2\*5P

R:REEL

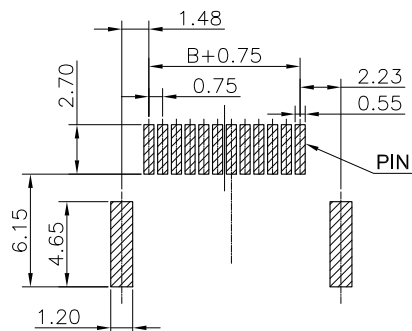
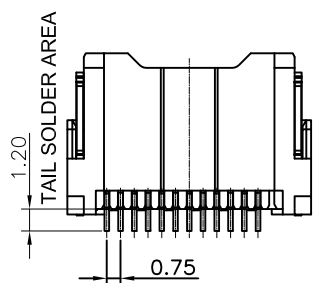
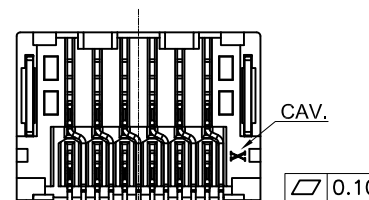
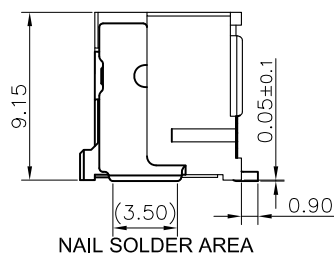
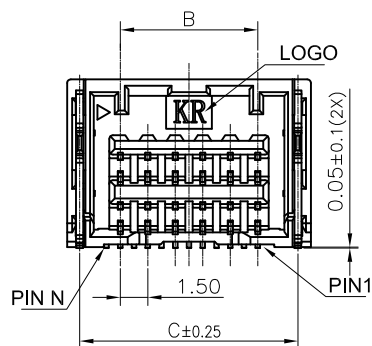
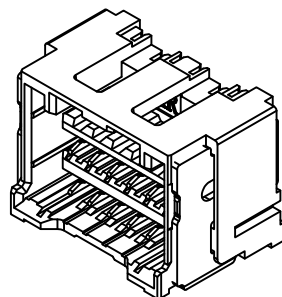
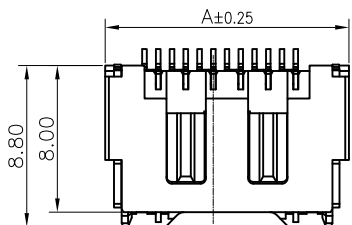

Recommended P.C.B. Layout  
Total tolerance: ±0.05mm

Pin	Dimension		
	A	B	C
2*4P	10.30	4.50	8.93
2*5P	11.80	6.00	10.43
2*6P	13.30	7.50	11.93
2*7P	14.80	9.00	13.43
2*8P	16.30	10.50	14.93
2*9P	17.80	12.00	16.43
2*10P	19.30	13.50	17.93
2*11P	20.80	15.00	19.43
2*12P	22.30	16.50	20.93
2*13P	23.80	18.00	22.43
2*14P	25.30	19.50	23.93
2*15P	26.80	21.00	25.43
2*16P	28.30	22.50	26.93
2*17P	29.80	24.00	28.43
2*18P	31.30	25.50	29.93
2*19P	32.80	28.00	31.43
2*20P	34.30	28.50	32.93

F	A3				TOLERANCE	TITLE:	DRAWN: Shen 2022.05.10	KONNRA 东莞市康瑞电子有限公司 DongGuan Konnra Electronics Co.,Ltd.			
	A2				X.X ±0.20	MX1.5 INNER BUCKLE	CHECKED:				
	A1	NEW DWG	Shen	2022.05.10	X.XX ±0.10	DUAL ROW SMT 90°	APPROVED:	PART NO.: C1507RS2xx11M0101RA			
	MARK	REVISION DESCRIPTION	SIGNATURE	DATE	X.XXX ±0.05	WF	UNIT:mm	SCALE:1/1	SHEET:1/2	PROJECTION	REV.:A1
	1	2	3	4	5	6	7	8	9		

**RoHS**  
COMPLIANT

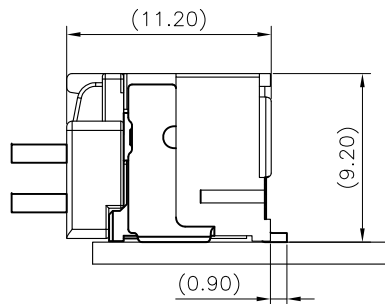

MATED CONNECTORS

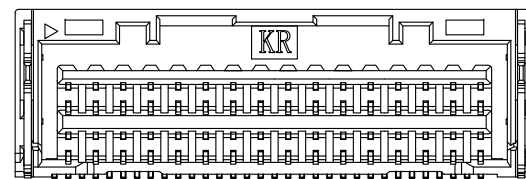
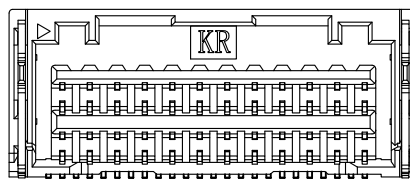
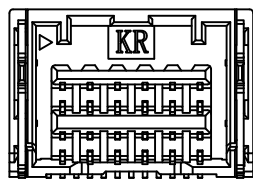
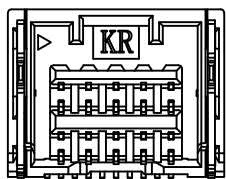
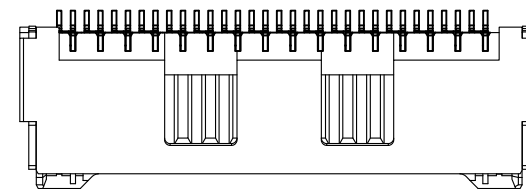
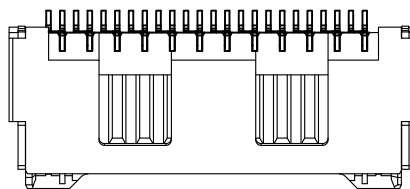
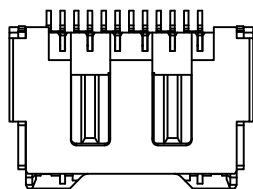
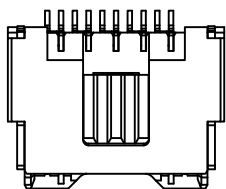

2x4~2x5PIN

2x6~2x9PIN

2x10~2x15PIN

2x16~2x20PIN

F					TOLERANCE	TITLE:	DRAWN: Shen 2022.05.10	KONNRA 东莞市康瑞电子有限公司 DongGuan Konnra Electronics Co.,Ltd.			
					X.X ±0.30	MX1.5 INNER BUCKLE	CHECKED:				
		NEW DWG	Shen	2022.05.10	X.XX ±0.20	DUAL ROW SMT 90°	APPROVED:	PART NO.: C1507RS2xx11M0101RA			
	MARK	REVISION DESCRIPTION	SIGNATURE	DATE	X.XXX ±0.10	WF	UNIT:mm	SCALE: 1/1	SHEET: 2/2	PROJECTION	REV.: A1
	1	2	3	4	5	6	7	8	9		



**RoHS**  
COMPLIANT

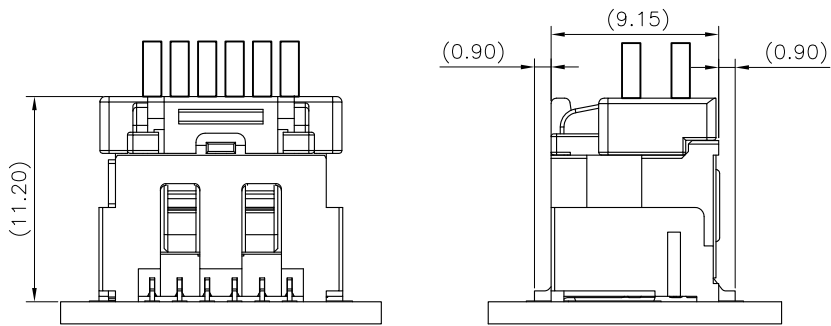

MATED CONNECTORS

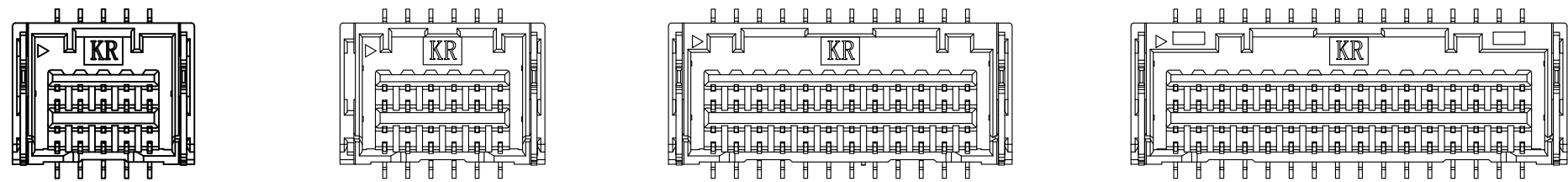
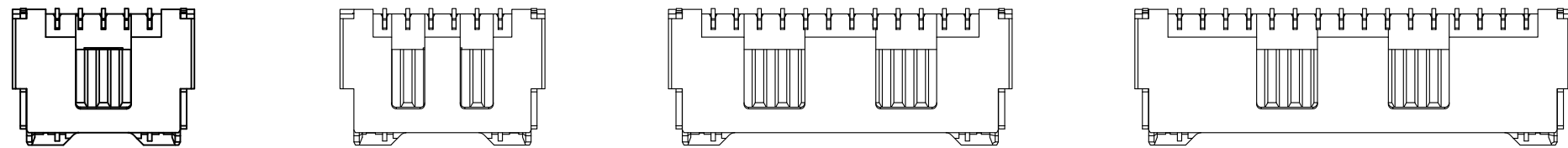

2x4~2x5PIN

2x6~2x9PIN

2x10~2x15PIN

2x16~2x20PIN

F					TOLERANCE	TITLE:	DRAWN: Shen 2022.05.10	KONNRA 东莞市康瑞电子有限公司 DongGuan Konnra Electronics Co.,Ltd.			
					X.X ±0.30	MX1.5 INNER BUCKLE	CHECKED:				
		NEW DWG	Shen	2022.05.10	X.XX ±0.20	DUAL ROW SMT 180°	APPROVED:	PART NO.: C1507VS2xx11M0101RA			
	MARK	REVISION DESCRIPTION	SIGNATURE	DATE	X.XXX ±0.10	WF	UNIT:mm	SCALE: 1/1	SHEET: 2/2	PROJECTION	REV.: A1
	1	2	3	4	5	6	7	8	9		